

Carbon steel Industrial Pressure Transducer

Description

XDB304 series of pressure transducers utilize ceramic pressure sensor core, ensuring exceptional reliability and long-term stability. With economical carbon steel alloy shell structure and multiple signal output options, they are widely used in various industries and fields.

Features

- ◆ Low cost & economical solutions
- ◆ Carbon steel alloy shell
- ◆ Complete surge voltage protection function
- ◆ Short circuit and reverse polarity protection
- ◆ Provide OEM, flexible customization

Typical applications

- ◆ Intelligent IoT constant pressure water supply
- ◆ Energy and water treatment systems
- ◆ Medical, agricultural machinery and testing equipment
- ◆ Hydraulic and pneumatic control systems
- ◆ Air-conditioning unit and refrigeration equipment
- ◆ Water pump and air compressor pressure monitoring



Parameters

Pressure range	-1~50 bar	Accuracy	$\pm 1.0\%$ FS@25℃ ($\leq \pm 2.0\%$ FS max -20...80℃)
Input voltage	DC 5V, 12V, 3.3V, 9-36V	Long-term stability	$\leq \pm 0.2\%$ FS/year
Output signal	0.5~4.5V / 1~5V / 0~5V / I ² C (others)	Response time	≤ 4 ms
Thread	G1/4, G1/8	Overload pressure	150% FS
Electrical connector	Packard / Direct plastic cable	Burst pressure	300% FS
Insulation resistance	> 100 MΩ at 500V	Cycle life	500,000 times
Operating temperature	-40 ~ 105 ℃	Housing material	Carbon steel alloy shell
Compensation temperature	-20 ~ 80 ℃	Sensor material	96% Al ₂ O ₃
Operating current	≤ 3 mA	Protection class	IP65
Temperature drift (zero&sensitivity)	$\leq \pm 0.03\%$ FS/ ℃	Weight	≈0.08kg

Dimensions(mm) & electrical connection

Packard

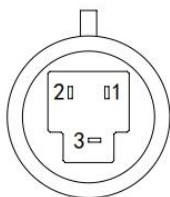

RED: +SUPPLY①

BLACK: GND②

YELLOW: OUTPUT+③

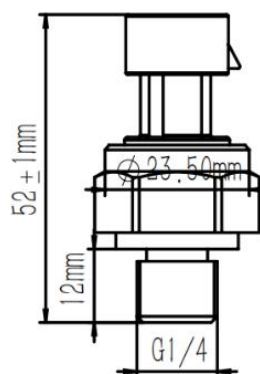

Direct plastic cable

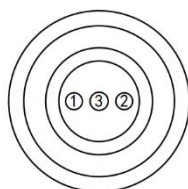

RED: +SUPPLY①

BLACK: GND②

YELLOW: OUTPUT+③

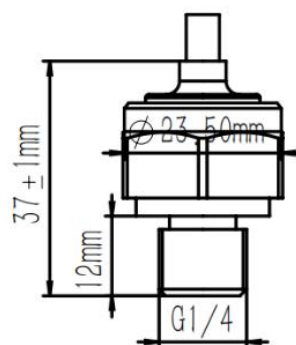

Packard Plug cable

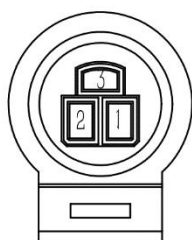

RED: +SUPPLY①

BLACK: GND②

YELLOW: OUTPUT+③

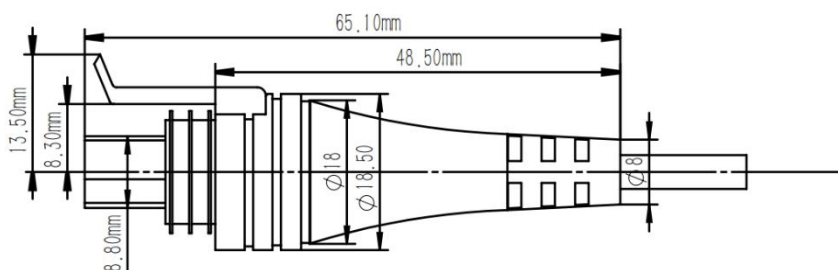

Output Curve (5±0.25V)

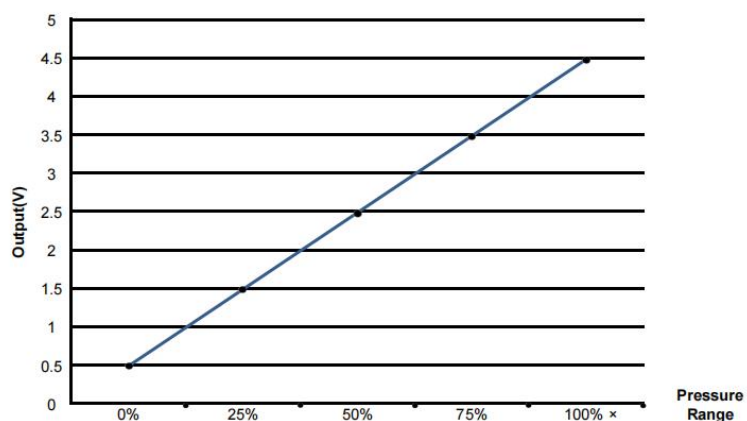

How to order

E.g. **XDB304- 150P - 01 - 0 - C - G1 - W2 - c - 01 - Oil**

1	Pressure range	150P
	M(Mpa) B(Bar) P(Psi) X(Others on request)	
2	Pressure type	01
	01(Gauge) 02(Absolute)	
3	Supply voltage	0
	0(5VDC) 1(12VDC) 2(9~36(24)VDC) 3(3.3VDC) X(Others on request)	
4	Output signal	C
	B(0-5V) C(0.5-4.5V) E(0.4-2.4V) F(1-5V) G(I ² C) X(Others on request)	
5	Pressure connection	G1
	G1(G1/4) X(Others on request)	
6	Electrical connection	W2
	W2(Packard) W7(Direct plastic cable) X(Others on request)	
7	Accuracy	c
	c(1.0% FS) d(1.5% FS) X(Others on request)	
8	Paired cable	01
	01(0.3m) 02(0.5m) 03(1m) X(Others on request)	
9	Pressure medium	Oil
	X(Please note)	

Notes:

1) Please connect the pressure transducer to the opposite connection for different electric connector.

If the pressure transducers come with cable, please refer to the right color.

2) If you have other requirements, please contact us and make notes in the order.

#98 Rongyang Rd, Songjiang, SH, 201613, CHINA

+86 19921910756

www.xdbsensor.com

+86 021 37623075

info@xdbsensor.com

Xidibei Sensor & Control